

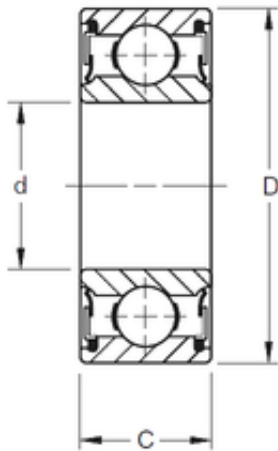

ASAHI FORGE OF AMERICA BEARING CORP.

50 mm x 90 mm x 30,18 mm Timken W210PP
deep groove ball bearings



Bearing No. W210PP

Size	50x90x30.18 mm
Bore Diameter	50 mm
Outer Diameter	90 mm
Width	30,18 mm
d	50 mm
D	90 mm
B	30,18 mm
C	30,18 mm
Weight	0,767 Kg
Basic dynamic load rating (C)	39000 kN

W210PP Bearing 2D drawings and 3D CAD models